



December 2, 2013  
JFE Engineering Corporation

## JFE and Myanmar's Ministry of Construction Establish a Joint Venture Company for Steel Structure Projects - A Steel Bridge Fabrication Plant to be Built in Yangon City -

JFE Engineering Corporation (President and CEO: Sumiyuki Kishimoto; Head Office, Chiyoda-ku, Tokyo) has established J&M Steel Solutions Company Limited<sup>\*1</sup>, a joint venture company committed to infrastructure construction, with Myanmar's Ministry of Construction, and has commenced the construction of a new plant.

JFE Engineering is pleased to announce that grand ceremonies to celebrate the establishment of the company and the groundbreaking for the new plant were held on December 1, 2013.

Myanmar has been enjoying dramatic economic development since its democratization in 2011, therefore, it urgently requires the construction of transportation infrastructure, such as roads and railways, as well as logistics infrastructure, including port terminals. Under such circumstances, J&M Steel Solutions plans to complete the construction of a steel structure fabrication plant with an annual capacity of 10,000 tons in Thaketa Township, Yangon City, by April 2014, to commence its business related to steel bridge design, fabrication and construction. JFE Engineering's high quality fabrication technologies will also be introduced to the plant. Consequently, in addition to steel bridges, the plant will be capable of fabrication harbor & coastal structures and container cranes. Thus, the joint venture company will gradually expand the scope of its business to general transportation and logistics infrastructure development.

With J&M Steel Solutions receiving orders for projects within Myanmar, which is expecting market expansion, the country's Ministry of Construction aims to increase the ratio of domestically fabrication of steel structures from its current low level of approximately 10%.

Meanwhile, JFE Engineering will leverage the joint venture company not only to receive direct project orders, but also as a production base for the expansion of its overseas steel structure business in Southeast Asian countries, the Middle East and Africa.

JFE Engineering is committed to further reinforcing the trust it has established with Myanmar over the past 20 years, and to offering its engineering expertise to the environmental and energy fields, in addition to the country's transportation and logistics infrastructure, in order to contribute to its development.

<sup>\*1</sup>: The establishment of the joint venture was agreed to between JFE Engineering and PW in February 2013. Procedures for the establishment have since been carried out, and a business license was granted in November.

\*2: JFE Engineering opened its Yangon Branch in 1995. It provides technical support to national companies regarding the construction of large bridges. Furthermore, it has been accepting over 200 welding trainees at its Tsu Works since 2002. It also started an internship training program for students of the Yangon Technological University in 2013 for the purpose of training future leaders of infrastructure construction. JFE Engineering has garnered a high degree of trust from its contributions related to the technical support and human resource development it provides to the country.

(Outline of the Company)

- Venture Partner: Public Works, Ministry of Construction, Myanmar
- Company Name: J&M Steel Solutions Company Limited
- Share Capital: 1.2 billion yen
- Investment Ratio: JFE Engineering Corporation – 60%  
Public Works, Ministry of Construction, Myanmar – 40%
- President: Yasuo Shoji
- Plant Outline: Annual production capacity – 10,000 tons, Land area – Approx. 65,000 m<sup>2</sup>
- Address: Thaketa Township, Yangon City (approx. 15 km from the city center)
- Line of Business: Sales, design, production and building functions
- No. of Employees: 210 employees(30 staff and 180 workers)  
\* To start with 80-90 employees (approx. 70 workers) in April 2014.
- Products: Bridges, harbor & coastal structures and other steel structure products



■ Site for the plant



■ Company establishment ceremony held on December 1.

(From left,) Senior Managing Director Ishii, President Kishimoto (JFE Engineering), President Shoji (J&M), Mr. Kyaw Lwin, Minister of Construction, Mr. Kyaw Linn, Managing Director, Public Works

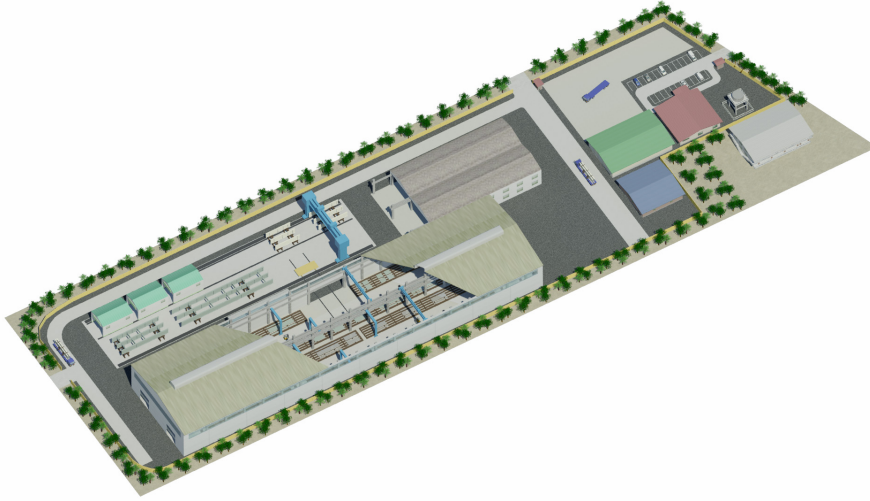

■ Conceptual drawing of the plant

---

For inquiries regarding this article,  
Please contact JFE Engineering Corporation at the following:

Overseas Project Dept, Bridge Structure Division, Steel Structure Engineering Sector  
JFE Engineering Corporation